

## **Professional Wall Mounted Accessories Fitting Instructions - Retractable Clothes Line – QA108641**

Thank you for purchasing this Croydex product. Please follow the fixing and care instructions to ensure your accessory is fitted safely and retains its high quality finish. **Please retain this leaflet for future reference.**

### **Fixing Pack Contents**

Fixing Screws x 4  
Wall Plug X 4

**NOTE - The wall plugs supplied are for solid walls only; use appropriate fixings for cavity walls**

### **Tools Required**

Drill; Pencil;  $\frac{15}{64}$ " (6mm) masonry drill bit;  $\frac{15}{64}$ " (6mm) ceramic drill bit (optional); Spirit Level; Cross head screwdriver; Small flat head screwdriver; Tape measure

**KEEP DIY TOOLS OUT OF THE REACH OF CHILDREN**

### **Safety and Care Advice**

1. Always take care when using an electric drill, particularly in the bathroom. Always check for hidden cables and pipework before drilling. Always use a residual current circuit breaker (RCCB/GFCI) when using mains powered tools and take extreme care if there is any water in the working area.
2. Always wear suitable eye protection when drilling.
3. If the product is to be fitted on a ceramic tiled wall, a ceramic drill bit should be used. Do not drill mounting holes in the grouted area between tiles. Mask the area around the hole with tape before drilling to prevent damage to the tile.
4. Do not use the product as a grab bar.

### **Instructions for fitting the Retractable Clothes Line**

1. Ensure the wall surfaces are strong enough to take the required load and use appropriate fixings for the wall material.
2. Mark the positions for the brackets opposite each other and at the same height. Note: maximum length of clothes line chord is  $96 \frac{7}{16}$ " (2450mm).
3. Place and mark the position of the clothes line body on the wall by accurately drawing around its circumference.
4. Position the key-hole plate on the wall directly opposite to the clothes line body and use it as a template to mark its screw hole positions.
5. Remove the fixing bracket from the clothes line body by loosening the small grub screw. (See Fig.1)
6. Centre the fixing bracket within the outline of the clothes line body and use it as a template to mark the screw positions on the wall surface. Ensure the orientation of the fixing bracket is correct. (See Fig.1)

7. Drill the holes to a depth of  $1 \frac{3}{8}$ " (35mm) in the marked positions using a  $\frac{1}{4}$ " (6mm) masonry drill. If the product is to be fitted onto a ceramic tiled wall, a ceramic drill bit should be used.
8. Insert the wall plugs flush to the surface of the wall. If fitting to a tiled surface, the wall plugs should be inserted below the surface of the tile to avoid cracking.
9. Insert the screws provided through the wall fixing bracket and the circular plastic gasket and screw them onto the wall. Ensure the wall bracket is vertical and in the correct orientation. (See Fig.1). DO NOT OVERTIGHTEN.
10. Insert the screws provided through the keyhole plate and the small oval plastic gasket and screw them onto the wall. Ensure the keyhole plate is vertical and in the correct orientation. (See Fig.1). DO NOT OVERTIGHTEN.
11. Place the clothes line body onto the fixing bracket and tighten the grub screw as shown. (Fig. 1)
12. Extend the clothes line chord (See Fig.2) and place the knob into the cradle. (See Fig.2)
13. Tighten the knurled nut to lock the clothes line chord in position. (See Fig.3)

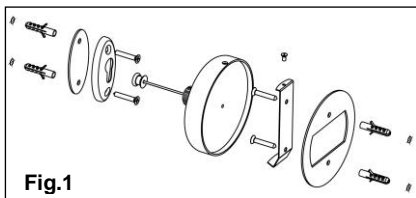

**Fig.1**

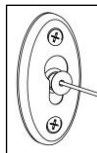

**Fig.2**

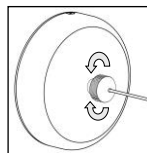

**Fig.3**

### **Additional Information**

Maximum safe working load for the clothes line is 11lb (5kg). Do not overload.

### **Product Care Advice**

- To retain the best quality finish, clean product regularly with a soft damp cloth.
- Do not use abrasive or chemical cleaners, as these will damage the product.

For details of the other items in the Croydex range please visit our website: [www.croydex.co.uk](http://www.croydex.co.uk)

Croydex, Central Way, Andover, Hampshire, SP10 5AW, UK

EU: MIL, Unit 8 Purcellsinch Ind Est, Dublin Road, Kilkenny, R95 HP71, Ireland

Tel: +44 (0) 1264 365881. Fax: +44 (0) 1264 356437

Website: [www.croydex.co.uk](http://www.croydex.co.uk). E-mail: [info@croydex.co.uk](mailto:info@croydex.co.uk)

WMA 049 R02